



East Midlands Regional Learning Disabilities Programme Board



Meeting held on

Thursday



April

2010

Minutes – What people said at the meeting

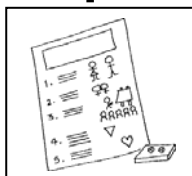

Apologies – Who could not come to the meeting



- John McIvor – Chief Executive NHS Lincolnshire
- Mick Connell, Lead Director, Adult Social Care
- Ian Davies, Regional Forum Representative
- Councillor David Sprason, Chairman

Present – The people who were at the meeting



- Ranjit Singh, Co-Chair/Regional Self Advocate Representative
- Aaron Keen, Supporter to Ranjit Singh
- Helen Mycock, Regional Valuing People lead
- Stephanie Chapman, Family Carer Representative
- Jo Burke – Supporter to Stephanie Chapman
- George Harvey, Family Carer Representative
- Rachel Holynska, Department of Health East Midlands
- Marie – Laure Huke– Government Office East Midlands
- Dave Marsden, NHS East Midlands
- Tom Smith, NHS East Midlands
- Charlotte Wilcockson, PSA 16 Regional Housing Programme Manager
- Andrew Milroy (Stand in for Mick Connell)
- Susan Hayes, note-taker

Introductions and roles of each board member



Everyone introduced themselves and talked about their roles.

- Marie-Laure Huke new to the meeting taking over from Abby Johnson-Brennan (Government Office East Midlands)
- Andrew Milroy deputising for Mick Connell (Derbyshire)

Ground rules and how the meeting will be run (paper 1)

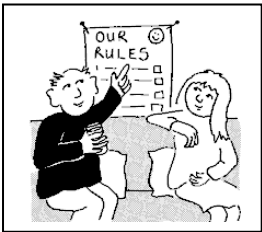

Aaron Keen reminded everyone of the Ground Rules for the meeting and Charlotte Wilcockson was asked to take on the Word Police role.

Notes of the last meeting held on 28th January 2010



Everyone agreed these were a correct record.

- Amendment made: Dave Marsdens name on apologies twice

Matters Arising and update on agreed actions

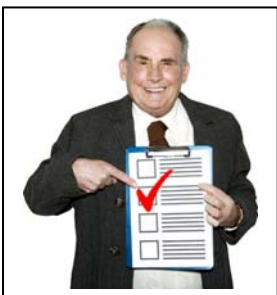

Latest version of the Regional Valuing People Now Delivery Plan (see paper 2)

- The National Valuing People Now Delivery Plan for 2010/11 was published in March 2010.
- The Regional Valuing People Now Delivery Plan for 2010/11 follows the same themes and big priorities (most important things)



Matters arising and up date on agreed actions Latest version of the Regional Delivery Plan (see paper 2) – Continued...

Helen Mycock talked through the updated version of the Regional Delivery Plan for 2010/11; which now includes the new priority 'Regional Plan for children and adults services working together'

The report provides a regional delivery plan covering:

- Person Centred Planning and personalisation
- Access to Health Care
- Plans for jobs
- Plans for getting a home
- Plans for including everyone
- Plans for what people do during the day, evenings and weekends'
- Regional Plan for children and adults services working together

Comments:

- Marie – Laure asked when will the figures in Appendix 2 (Regional Funding Plan) be released?

Answer: The figures will be available in May and included in time for the next meeting.

- Rachel Holynska talked about working jointly with the Strategic Health Authority (SHA) on the housing plan, including using Assistive Technology and buying in special help to support reviews of placements of people with challenging behaviour as advised by a recent report by Professor Mansell called 'raising our sights'.
- Dave Marsden said the document was well produced but for future versions maybe we need to look at the way we measure our success; for example: highlight more numbers in the plan. Also it would be good if a 1 page summary plan could be put together (**Helen to action**)





Matters arising and up date on agreed actions Latest version of the Regional Delivery Plan (see paper 2) – Continued...

Comments:

- Andrew Milroy gave caution to producing more numbers; as it is not always about reaching a target, sometimes it is better to work steadily with a higher standard of work than to rush through plans in order to reach the targets.

The plan was agreed in principle.

Action: (Working progress) Helen Mycock will update the report as and when we get the data.

Partnership Board Peer Review Pilot

Helen Mycock reported that the first national pilot had taken place over 3 days at the end of March with Derby City Partnership Board.

The Improvement and Development Agency (IDeA) have led the pilot and will be producing a final report

This document is not a public document, but Derby City may choose to share some of its final report.

The pilot had helped to put together a model for the review of Partnership Boards and a series of questions called 'Key Lines of Enquiry'.

Action: Helen Mycock will contact IDeA and ask if the Key Lines of Enquiry can be shared and also ask what the cost of further Peer reviews will be.

3. Working together on supporting Transition for young people with disabilities, Helen reported that it has been agreed that a joint board meeting will be held with the Regional Aiming High Board on 22 July 2010

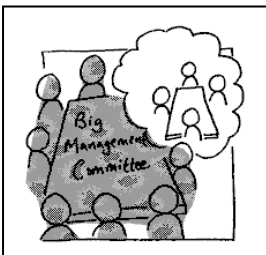

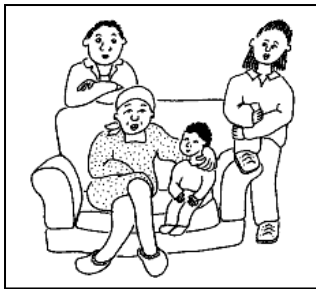

Update - Regional Valuing Families Forum and network (groups)

Step Chapman told the board about a new report on Supporting Older Family Carers, which is available on the Valuing People website.

<http://valuingpeople.gov.uk/dynamic/valuingpeople6.jsp#olderfamilies>

Action: Susie to forward on a copy of the report to everyone on the Board.

Steph Chapman did a presentation on family carer's feedback in the region (Paper 3)

This included:

News from the region;

- Regional launch of Older Carers and Mutual Caring Resources
- Training for local Authorities on carer assessments
- Regional Carer open forum on Personalisation

Feedback from the family carers in the 9 localities.

Comments

Dave Marsden asked about the problems and concerns in some of the regions.

It was discussed and agreed that Steph would ask family carers to give examples and feedback, so that we can make sure these concerns are being raised at the Partnership boards and are being addressed locally.

Helen Mycock suggested the report from family carers would go to the Partnership boards, who could respond through their quarterly report.

Action: Steph to get detailed examples and feedback from Family Carers and Helen to take to the Partnership board and collate the response for the Regional Programme Board.

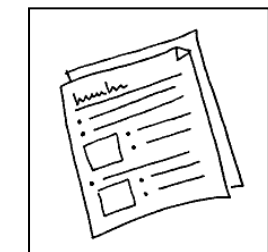



Update - Regional Valuing Families Forum and network (groups) Continued...

George talked about family carers concerns about personalisation and about local problems in understanding and completing the RAS (Resource Allocated System) form. George asked whether the Board could get local areas to use the same forms and ways of providing personalisation.

Comments:

Rachel Holynska said that although the Department of Health Regional Social Care Teams helps personalisation leads to share their developments and good practice, that local areas can develop their own forms and ways of offering personalisation. Rachel advised George to talk to his own local council about any problems in using or understanding forms.



Steph said that at the family carers forum on personalisation all 9 areas have taken away 20 questions based on common concerns from family carers and that answers would be shared.



Andrew Milroy mentioned that Derbyshire had produced a communication DVD put together with the help of people with learning disabilities and family carers.

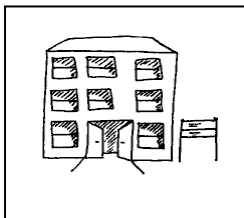

NHS Campus Closure updates (paper 4):

Dave Marsden showed and talked about the month by month plan for closing all of the campuses in the East Midlands region.

- He said that there is a lot of pressure to complete the closures by December 2010.
- The East Midlands Region has the largest number of people living in campuses is a small Strategic Health Authority (SHA).
- The concern is that we need to balance the needs of people against the targets.

NHS Campus Closure update:

Comments:

Rachel Holynska asked if she could share the data at the National Meeting , Dave Marsden agreed to this.

It was agreed that further reports on progress would be provided at every board meeting during 2010.

The SHA will be monitoring every month.

Ranjit asked what happens to people who need 24 hour support?

Helen said that everyone who was moving from Health Campuses had high needs and would be supported 24 hours a day and that everyone had been supported to have a PCP to say what their needs were to help them decide where to live and who with.

Updates – East Midlands Regional Valuing People Now annual report 2009/2010. (Paper 5a and 5B easy read).

Helen gave an over view of the annual reports received from partnership boards. She talked through the draft regional report she has put together including:

- What we have done well?
- What have we found the most difficult?

It was agreed that the final decision on the above would be made by the Partnership Board leads (Helen to lead by emailing a list to leads and asking for their views)

- Partnership Boards annual reports
- What has been done locally since the 'Six Lives' report?
- Better Healthcare
- Where people live
- Getting a Job and young people in transition
- Person Centred Planning
- Improving the workforce (people who are paid to support you)
- Involvement in Checking Services
- Keeping People Safe
- Partnership Boards and Checking services
- Regional Work Programme 2009 /2010
- The big Regional plans for 2010/ 2011
- Making it happen for everyone (good practice examples)

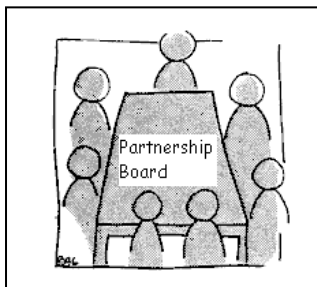
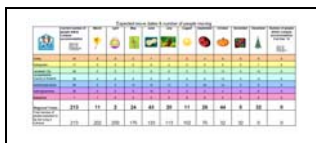



The Board agreed the contents of the report in principal; a final copy will be circulated when ready.

The Department of Health are setting up an email address for comments to be sent to on how partnership boards found putting the report together. This will be collected at the Partnership Board leads meeting in June.

Comments:

Andrew Milroy said it was a helpful process to produce the report, but the information given was from the previous year and not showing what is happening to date. Rachel said that this was because the information had to be the same for the same time period from each area, and had to have been sent to and checked by the Government.

Rachel said that she was putting together the National report and that it would be good to get some good practice examples from the region.

Action: Helen will collect good practice for the national report and also put together a regional good practice report.

Helen make changes so that the final report can be sent to the National Learning Disabilities programme Board by the end of May 2010.

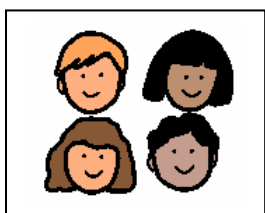

Agenda Items for the next joint meeting with the Children's aiming high board:

- Update on employment and Getting A Life projects
- Proposals from the Regional Transitions Boards on joint working (including the management of high cost placements for young people with complex needs)
- Funding arrangements for Further Education for young people (following Learning and Skills Council funding moving to Councils)
- Update from Regional Forum for people with learning difficulties.
- Items from the Aiming High Board.

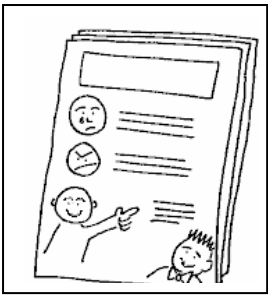

10 Any other business

None



11 Date and time of next meeting

- Date: 22nd July 2010
- Time: 1.30 pm to 4pm
- Venue: County Hall Leicestershire